

Fantasea Line

Lens Gear SEL1018 (Cat. No. 2211)

Instruction Manual

The **Lens Gear SEL1018** enables using the zoom ring of the **Sony SEL1018** lens when used inside housings featuring the Fantasea FML port system. The focus ring of the SEL1018 lens cannot be accessed using this gear. For housings and lenses compatibility information, please visit the Fantasea website – www.fantasea.com

SPECIFICATIONS

- Material: PLA
- Dimensions (diameter x height): 83 x 37 mm / 3.27 x 1.46 inch
- Weight: 30 g / 1.05 oz
- Manufacturer's warranty



IDENTIFICATION OF PARTS

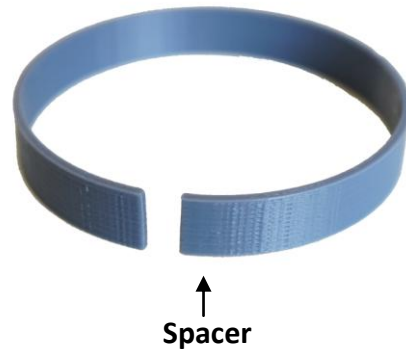

ASSEMBLY INSTRUCTIONS

1. The Lens Gear SEL1018 should be installed on the Sony SEL1018 lens prior to mounting the lens on the camera.
2. Remove the rear cap of the lens.
3. Hold the Lens Gear facing the rear side of the lens so that the gear teeth are pointed away from the lens (Fig.1).
4. Install the Lens Gear on the lens by sliding it from the back of the lens towards its front. Push the Lens Gear all the way in, until encountering resistance caused by the widening of the lens (Fig.2).

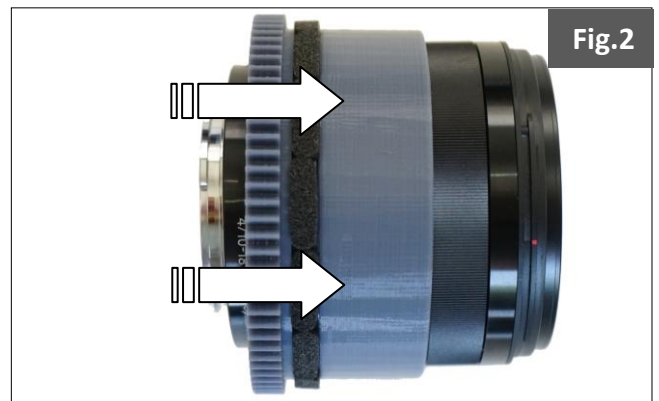

5. Hold the Spacer facing the rear side of the lens so that the gap on the Spacer is aligned with the white dot on the lens mount (Fig.3)
6. Install the Spacer by sliding it from the back of the lens towards its front, so it enters the gap between the Lens Gear and the lens (Fig.4). Push it in as far as it goes, making sure that the gap on the spacer remains aligned with the white dot on the lens mount (Fig.5).

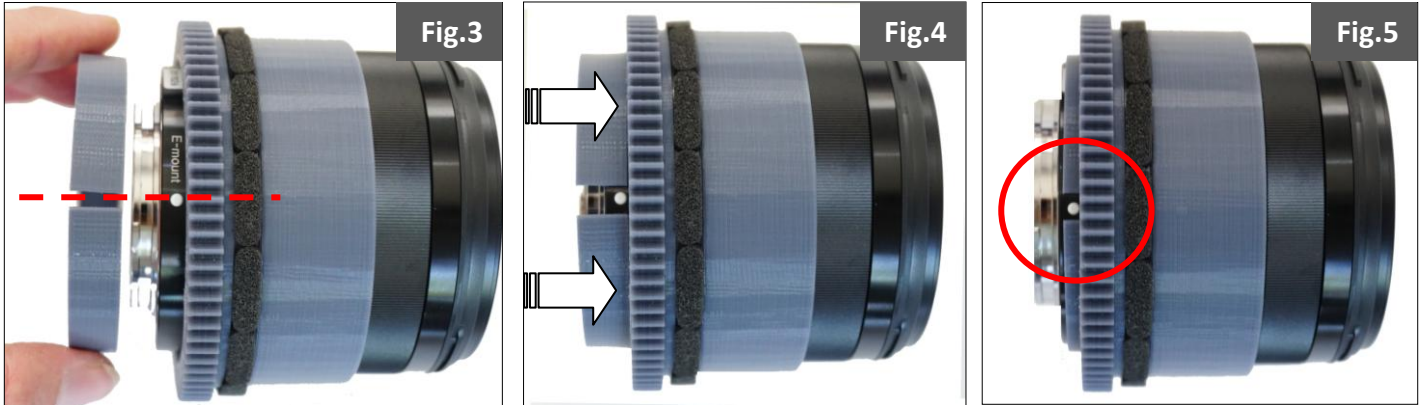

7. Mount the **Sony SEL1018** lens on the camera as described in the camera instruction manual.
8. It is recommended to install the camera inside the housing prior to installing the dome port with port extension.
9. Install the camera inside the housing as described in the housing instruction manual. During camera installation, it is recommended to turn the housing Lens Dial in order to allow the gear teeth of the housing to smoothly align with the gear teeth on the Lens Gear.
10. During camera installation inside the housing, the Lens Gear might be pushed backwards and out of its proper position. To push it back into place, either pull it from the front (Fig.6) or push it from the back of the housing (Fig.7) towards the widening of the lens.

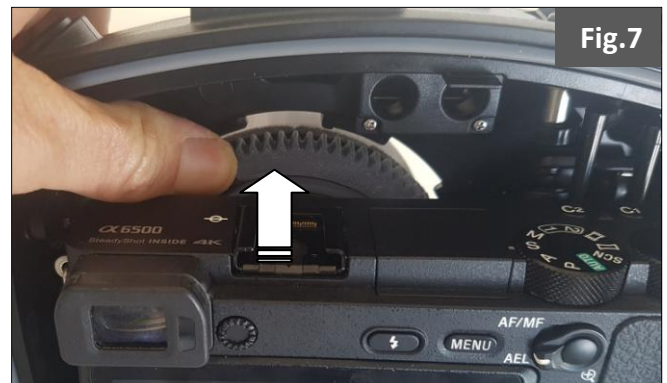

11. Test the housing Lens Dial by turning it in both directions (clockwise and counterclockwise) to ensure proper operation of the zoom ring.
12. **Note that the only proper position of the Lens Gear is when pushed forwards all the way towards the widening of the lens, as demonstrated in Fig.8 (on the following page). Any other position of the Lens Gear will result with failure to operate the housing Lens Dial control and to block the output of light sources inside the housing from reflecting on the dome.**



13. Install the FML Port Extension 25 (#2121) on the FML Dome Port A6 (#2111) as described in the port extension instruction manual.
14. Mount the port extension and dome port on the housing as described in the housing instruction manual.
15. Prior to closing the housing, test the housing Lens Dial again. If required, reposition the Lens Gear on the lens as described in step 10 above.
16. Close, seal and lock the housing as described in the housing instruction manual.

CARE & MAINTENANCE

1. Please use the utmost care and do not use excessive force when assembling and disassembling the different parts, in order not cause any damage to the products.
2. During installation, removal, storage and transportation, take special care not to damage the spongy shading pad featured on the Lens Gear.
3. Keep the Lens Gear away from extreme high temperatures, as under direct sunlight, since it might damage the product.
4. Do not clean the Lens Gear with any chemical solvents or other materials, which might cause damage to the product.
5. When storing the Lens Gear and during transportation, make sure that it is properly protected in order to prevent deformation of the product.
6. Do not store the Lens Gear in presence of chemicals, solvents or fuels.



FANTASEA PRODUCT CONSUMER LIMITED WARRANTY

“Fantasea” warrants this Fantasea Line branded product against defects in materials and workmanship under reasonable use for a period of ONE (1) YEAR, (two years, where required by law as determined by the origin of the authorized dealer). This warranty is effective from the date of retail purchase from Fantasea or an authorized Fantasea dealer, by the original end-user purchaser (“Warranty Period”). This warranty does not cover any commercial use of the product. If a product defect arises and a valid claim is received within the Warranty Period, at its option, Fantasea, or its authorized service facilities will either (1) repair the product defect at no charge, (2) exchange the product with a product that is new or which has been manufactured from new or serviceable used parts and is at least functionally equivalent to the original product. The warranty will not extend beyond the original warranty period. Your Fantasea Product should be registered within 30 days of purchase. You must keep the proof of purchase which indicates the date on which the purchase was made; as you may be required to show proof of purchase if you need warranty service. The following conditions apply: 1. This warranty extends to the original purchaser only. It is not assignable or transferable. 2. The warranty does not cover damage resulting from misuse, abuse, negligence, or accidents. Proper maintenance of the Product is the responsibility of the owner. 3. The warranty does not cover damage directly or indirectly resulting from the use of unauthorized replacement parts or service performed by unauthorized facilities. 4. This warranty does not cover any damage to any other product used in conjunction with the Fantasea product, including cameras and lenses, and resulting from any defect in the product materials or workmanship. 5. The cost of sending the product back to Fantasea or its authorized service facilities is the responsibility of the customer. 6. The warranty does not cover any incidental damages resulting from any defects in the product. This expressly includes any travel reimbursements or any other costs associated with the purchaser’s optional use of the product. The conditions of this warranty are expressly in lieu of all other expressed warranties, including the payment of consequential or incidental damages for the breach of any warranty. Please register your product on line at this URL: <http://www.fantasea.com/registration>

For further information - www.fantasea.com, info@fantasea.com