

ASSEMBLY INSTRUCTION

Model : D2279DT

Description : DINING TABLE

Thank you for purchasing this quality product. Be sure to check all packing material carefully for small parts that may have come loose inside the carton during shipment.

Step 1:

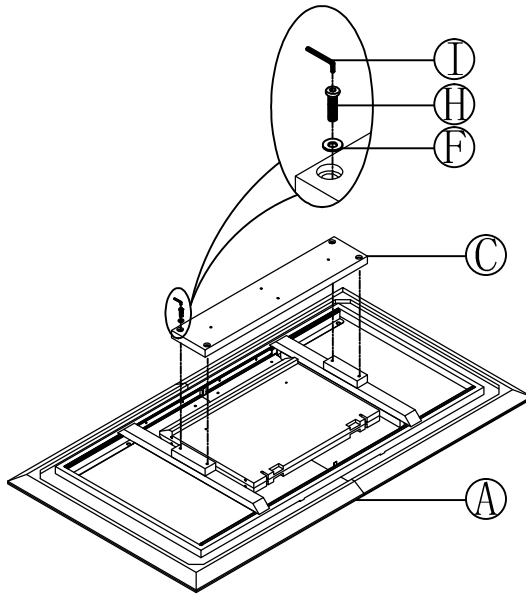

Step 2:

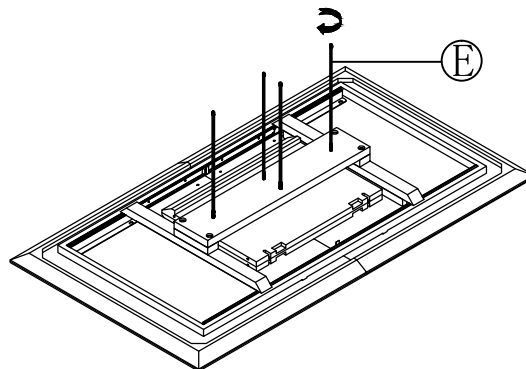

Step 3:

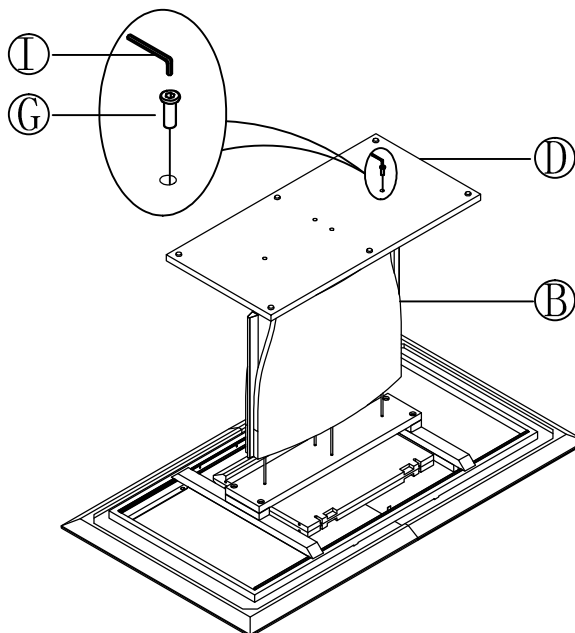

PART LIST :

No.	Description	Diagram	Quantity
A	table top		1
B	Column		1
C	wood plate		1
D	table base		1

HARDWARE LIST :

No.	Description	Diagram	Size	Quantity
E	Stud		M8 x 615mm	4
F	Flat washer		Ø20 x10mm	4
G	nut		M8 x 25mm	4
H	Bolt		M8 x 35mm	4
I	Allen key		M5	1

Finished

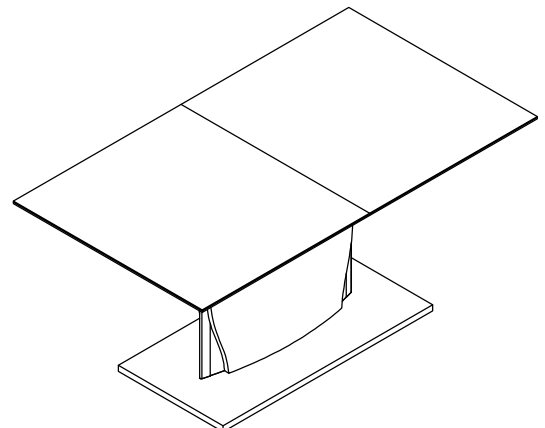

Made In China

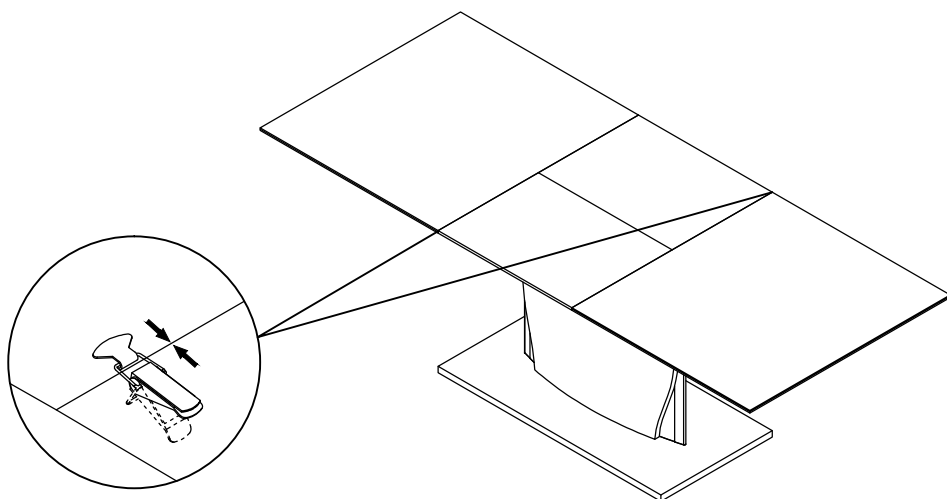
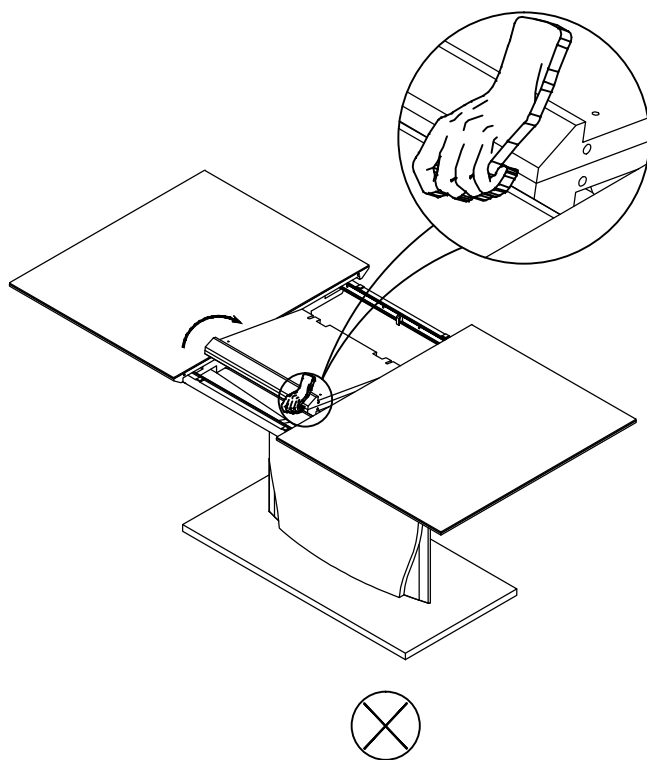
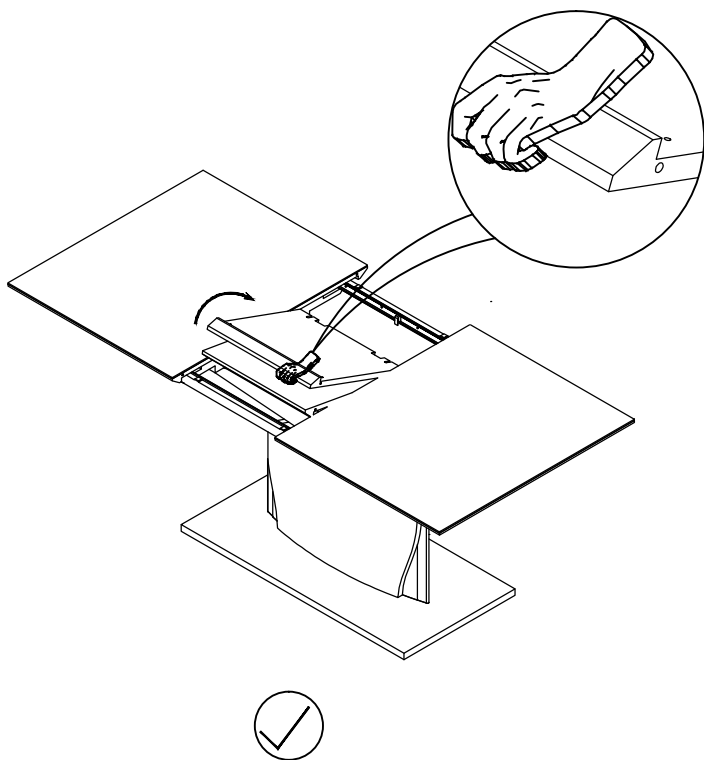
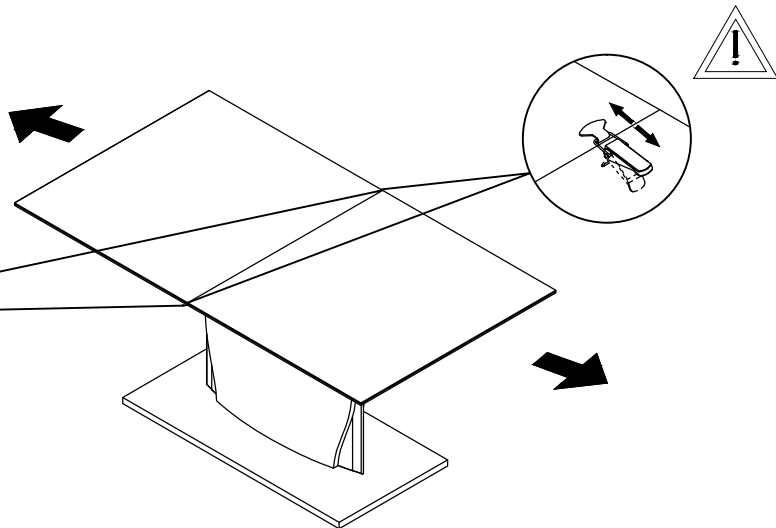
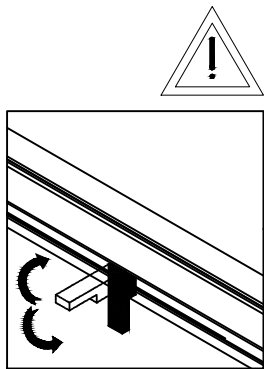

ASSEMBLY INSTRUCTION

Model : D4878DC

Description: DINING CHAIR

Thank you for purchasing this quality product. Be sure to check all packing material carefully for small parts that may have come loose inside the carton during shipment.

STEP 1

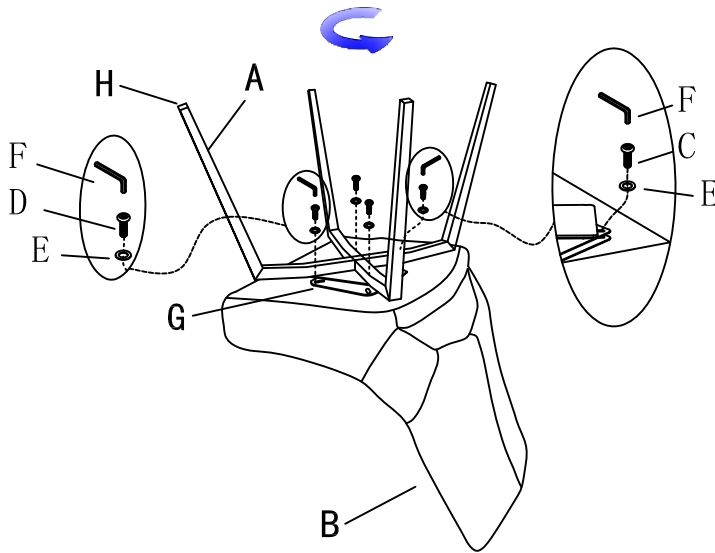

PART LIST:

NO.	Description	Diagram	Quantity
A	Legs		1
B	Backrest		1

HARDWARE LIST:

C	Bolt M6X16mm		2
D	Bolt M6X30mm		2
E	flat washer Ø16		4
F	Allen Key M4		1

PRE-FIX HARDWARE LIST:

G	Mechanism plate		1
H	Plastic feet		4

Assembly backrest(B) to the legs(A) with bolt(C) and bolt(D) by using flat washer(E) and allen key(F)

STEP 2

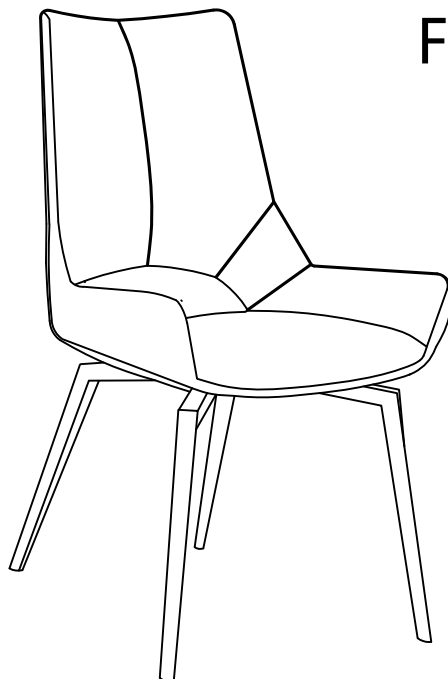

Finished

Made In China