

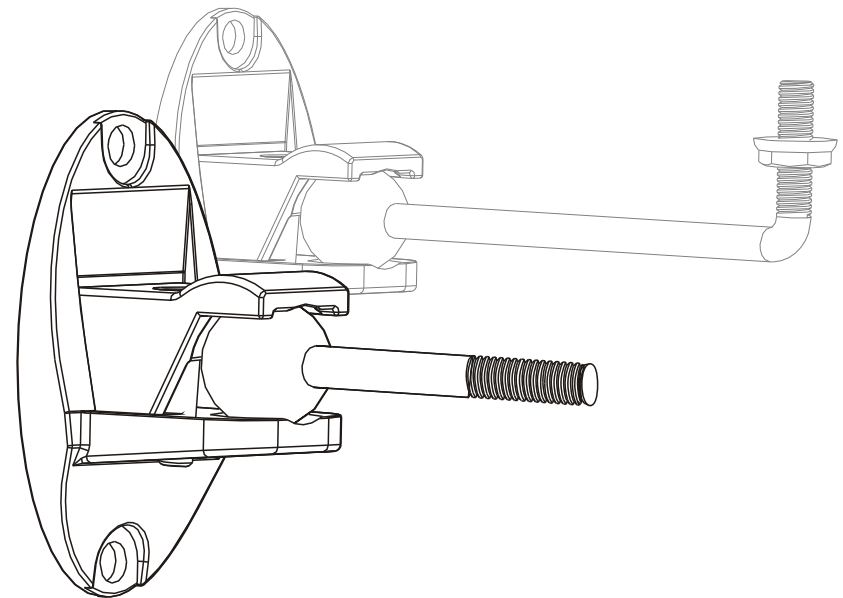

PIVOTING WALL/CEILING BRACKET



SB-27N



CAUTION: DO NOT EXCEED
RATED LISTED WEIGHT. SERIOUS
INJURY OR PROPERTY DAMAGE
MAY OCCUR!

NOTE: Read the entire instruction manual before you start installation and assembly.

THANK YOU!

Thank you for choosing the SVS SoundPath Pivoting Wall/Ceiling Bracket for your speaker mounting needs. This bracket is designed to offer directional flexibility in nearly any room with a strong, safe and reliable mounting solution for both walls and ceilings. The SVS SoundPath bracket is easy to install and works great in any surround sound or height effects application because the installed speaker can be pointed in nearly any direction.

We engineered our SoundPath Wall/Ceiling Bracket with the same precision as all of our speakers and subwoofers, so you know you're getting the best mounting solution available. If you have any questions about installation or placement, don't hesitate to contact our Sound Experts Customer Care team.

NEED HELP?

Let us know! We're always standing by to help with installation, system configuration, or any other set-up questions. Just call, email or chat online with our Sound Experts Customer Care team:

(877) 626-5623 | custservice@svsound.com | www.svsound.com

⚠ WARNING

- Read and understand all the instructions and warnings before installation.
- The mounting bracket was designed to be installed and utilized **ONLY** as specified in this manual and improper installation may cause damage or injury.
- Before starting, make sure the mounting surface will safely support the combined weight of the speaker and all attached bracket hardware and components.
- If mounting to wood wall studs, please make sure that mounting screws are anchored into the center of the studs.
- Tighten bracket screws firmly, but do not over-tighten as this can reduce holding power and cause damage to the wall or speaker.

Component Checklist

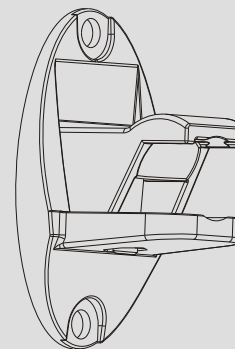

wall / ceiling plate **x2**
A

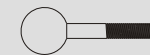

ball shaft (wall mount) **x2**
B

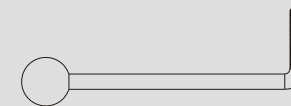

ball shaft (ceiling mount) **x2**
C

Package M:

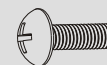

M6x14 **x2**
M-A



threaded stud **x2**
M-B



4mm Allen key **x1**
M-C

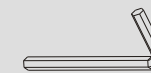

3mm Allen key **x1**
M-D



extra jam nut **x2**
M-E

Package W:



ST5.5x50 **x4**
W-A

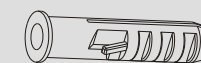

wall anchor **x4**
W-B

1. Speaker Options

A Prime Satellite / Keyhole Bracket

- 1 Remove Prime Satellite keyhole bracket from the speaker with the included 3mm Allen key (**M-D**)
- 2 Assemble M6 screw (**M-A**) to threaded stud (**M-B**) after inserting it through the Prime Satellite keyhole bracket
- 3 Reassemble keyhole bracket with M6 screw (**M-A**) and threaded stud (**M-B**) to Prime Satellite speaker.
- 4 Attach desired ball shaft mount to threaded stud

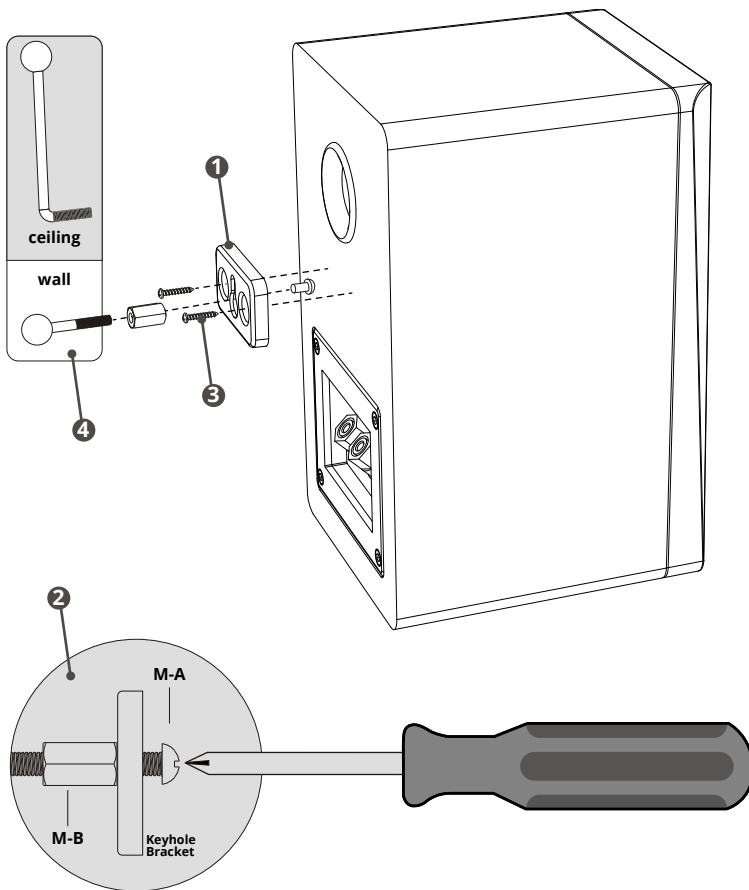
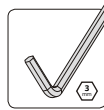

B Threaded Insert

If your speaker includes an integrated 1/4-20 threaded insert, either ball shaft can be mounted directly to the speaker.



- 1 Thread jam nut (**M-E**) onto desired ball shaft.
- 2 Screw ball shaft assembly into the 1/4-20 threaded insert of your speaker.
- 3 Tighten the jam nut (**M-E**) against your speaker, locking the ball shaft assembly in place.

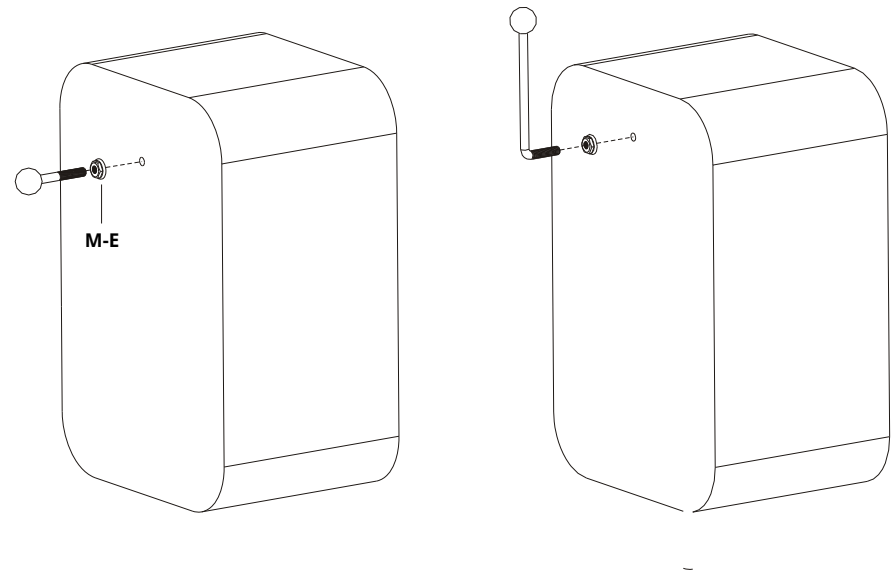

2a. For Wood Stud Wall Mounting

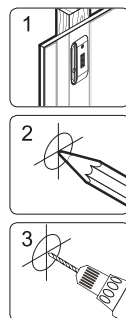
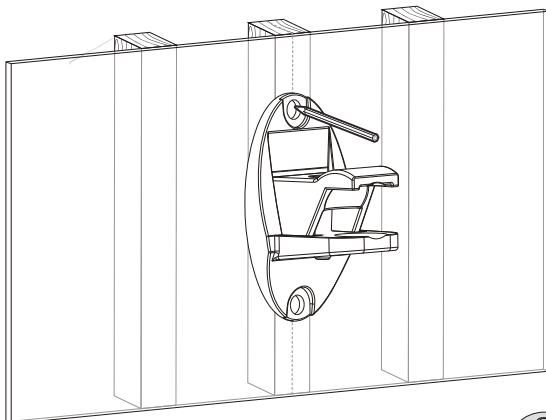
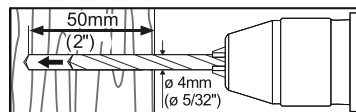

Drill pilot holes

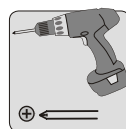
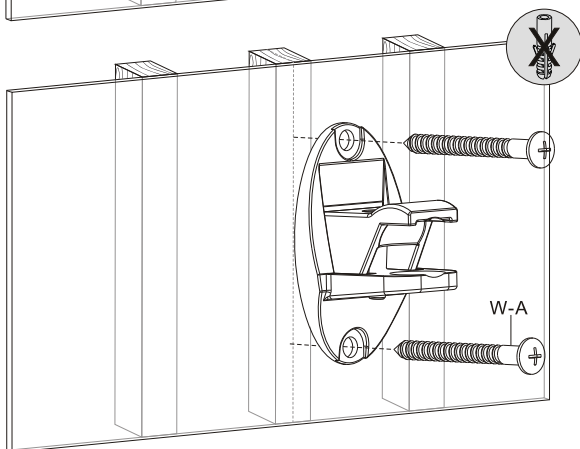

Screw the wall plate onto the wall

⚠ WARNING

- Make sure that mounting screws are anchored into the center of the studs.
- Installers are responsible for providing hardware for other mounting solutions.
- Verify that the supporting surface will safely support the combined weight of the equipment and all attached hardware and components.

2b. For Solid Brick and Concrete Mounting

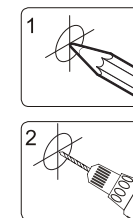
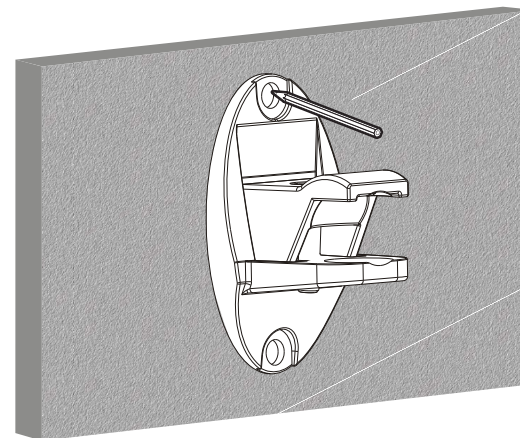
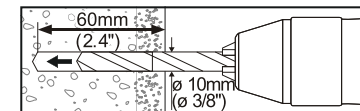
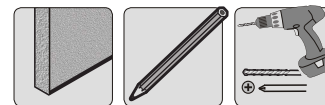

Drill pilot holes

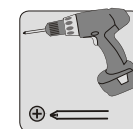
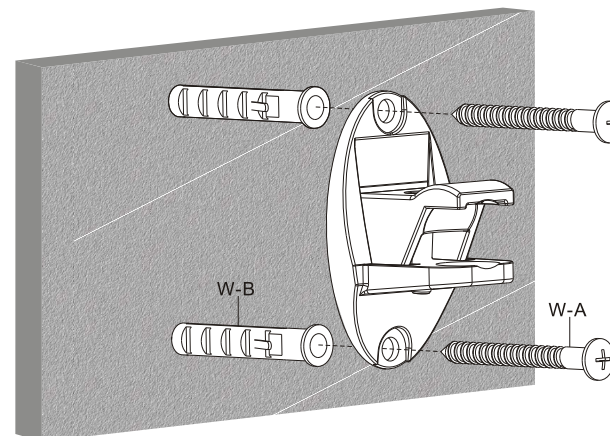

Screw the wall plate onto the wall

⚠ WARNING

Verify that the supporting surface will safely support the combined weight of the equipment and all attached hardware and components.

Install speaker on the ceiling

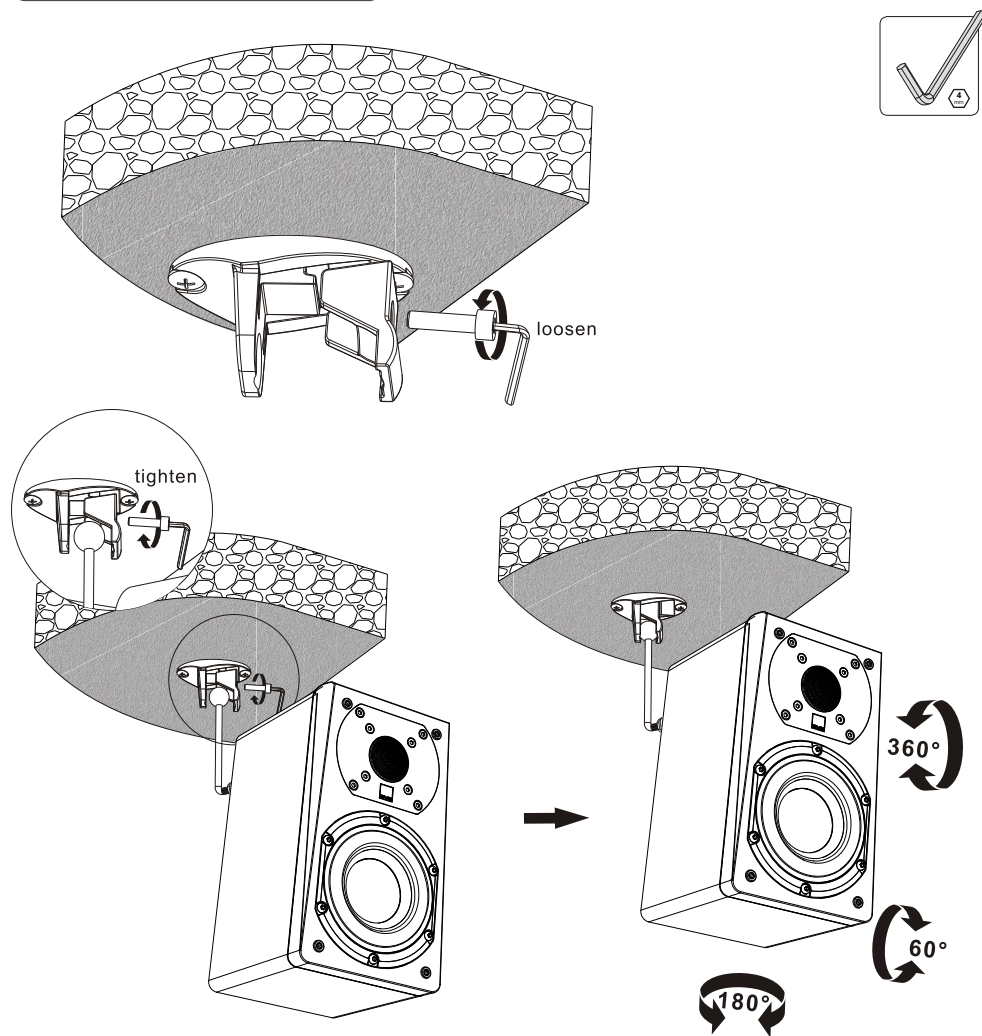

Adjust the speaker to the desired angle and re-tighten the bolt to secure the speaker.

Make sure the speaker is correctly installed and the bolt is tightened safely before releasing speaker.

Maintenance

- Check that the bracket is secure and safe to use at regular intervals(at least every three months).
- Please contact your dealer if you have any questions.