

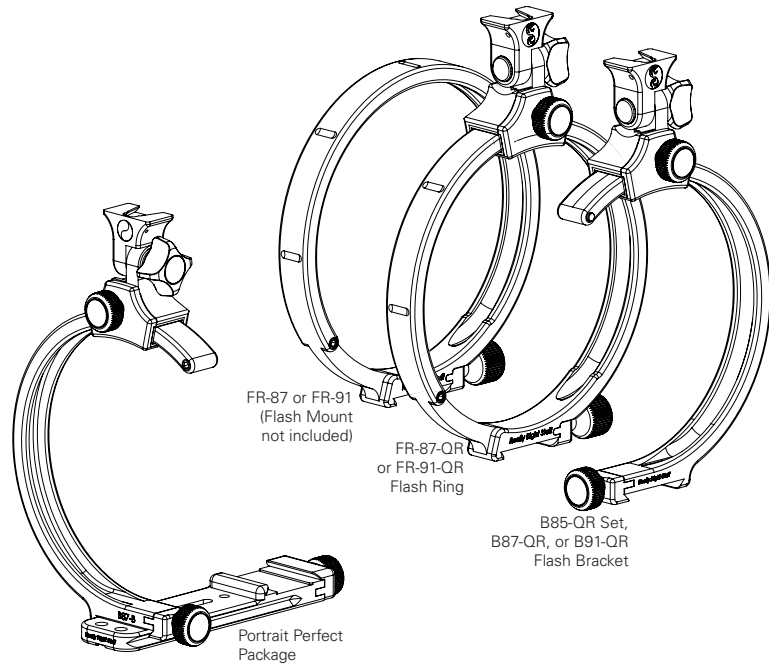

1146 Farmhouse Lane, San Luis Obispo, CA 93401 USA
 1-805-528-6321 | 1-888-777-5557
 www.ReallyRightStuff.com

FLASH BRACKETS, FLASH RINGS, AND PORTRAIT PERFECT PACKAGES



SPECIFICATIONS:

Half-Ring Models, one Flash Mount included.....B85-QR Set, B87-QR, B91-QR
 Full-Ring Models, one Flash Mount included.....FR-87-QR, FR-91-QR
 Full-Ring Models, no Flash Mount included.....FR-87, FR-91
 Flash Mount Tilt.....180° (90° forward, 90° backwards)
 Height to Cord Mount.....varies from 7 1/4 inches to 9 3/4 inches
 Interior Clearance.....varies from 4-5/8 inches to 7 inches
 Weight of Half-Ring Models.....varies from 7.4 ounces to 8.3 ounces
 Weight of Full-Ring Models with Flash Mount.....varies from 10.1 ounces to 11.1 ounces
 Weight of Full-Ring Models without Flash Mount.....from 6.1 to 7.2 ounces
 Weight of B87-QR Portrait Perfect Package.....11.9 ounces (337g)

Flash Brackets include one each FA-QR1 adapter, 1/4"-20x3/8 flat head screw, 5/32" hex key. Portrait Packages also include one each MPR-CL rail, M3x6mm safety stop screw, and M2.5 hex key.

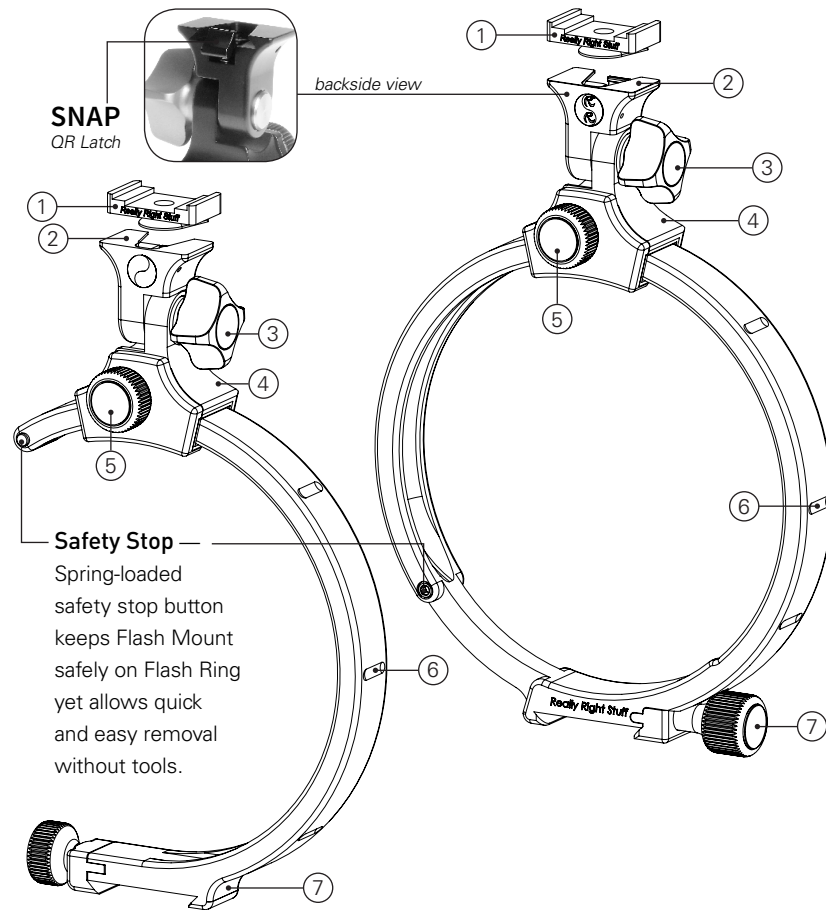

MOUNT TO TELEPHOTO LENS FOOT

Attach Flash Bracket to Lens Plate / Rail / Replacement Foot

Loosen QR Lock Knob and slide Flash Bracket into dovetail groove of quick-release plate. Quick-release plate must have at least 3/4" of dovetail free to mount a flash bracket. Tighten QR Lock Knob.

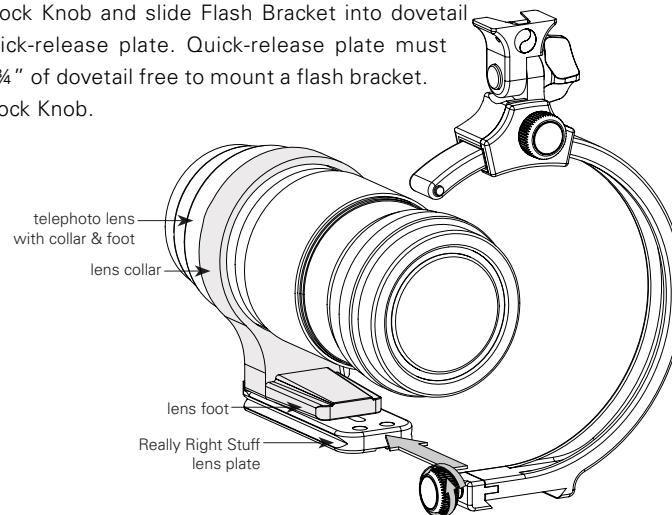

KEY FEATURES

Really Right Stuff flash brackets incorporate our patent pending **SNAP™** QR system for fast mounting and positioning of strobes. The system has two elements that snap together:

- a **SNAP** QR adapter that mounts to the bottom of your strobe or accessory.
- a **SNAP** QR mount that accepts the QR adapter.

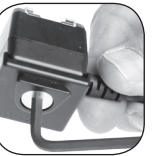

- 1. SNAP QR Adapter** — One FA-QR1 adapter is included with each flash bracket. Adapter mates perfectly with all Canon & Nikon* strobe cords; may also fit other strobe cords. Install adapter to bottom of strobe cord.
- 2. SNAP QR Mount** — Allows quick & secure snap-fit for strobes and flash accessories. To release, press QR latch at back.
- 3. Tilt Lock Knob** — Ergonomic knob drives locking mechanism to hold even the heaviest strobe in place. Mount delivers 180° of fore-aft tilt.
- 4. QR Flash Mount** — Flash Mount orbits around the lens to quickly reposition the flash above the lens in either portrait or landscape orientation. Flash brackets marked "87" accept B87-QRFM flash mounts. Flash brackets marked "91" accept B91-QRFM flash mounts.
- 5. Flash Mount Orbit Lock Knob** — Rotate clockwise to lock Flash Mount securely anywhere along Flash Ring.
- 6. Flash Ring with Detents** — Positive position Detents allow Flash Mounts to be quickly positioned "on the go." Rings (and Flash Mounts) are reversible. Choose either fully circular flash rings or half-ring flash brackets.
- 7. Quick-Release Clamp with QR Lock Knob** — Mount Flash Bracket to any Really Right Stuff lens plate, rail, or replacement foot with double-dovetail design. In order to use your collared telephoto lens with any Really Right Stuff clamp or flash bracket, you must fit your lens foot with a quick-release lens plate, rail, or replacement foot; purchase separately.

SNAP™ QR System at Work

Fasten FA-QR1 adapter to strobe cord. Press down on the QR Latch at back of Flash Mount and slide strobe cord into top of Flash Mount until it snaps into place. Install other end of strobe cord in camera's hot shoe. Mount strobe in strobe cord.



* The Nikon SC-29 strobe cord requires the Really Right Stuff FA-QR29 adapter. Other strobes may require adapters; check our website for compatibility.

PORTRAIT PERFECT PACKAGE

Attach to Camera Body When Using Non-Collared Lenses

The B87-QR & B91-QR mount directly to the lens plate on collared telephoto lenses, but what about your shorter lenses? Add our MPR-CL rail and gain the same functionality that you get with your collared lenses. Our Portrait Perfect Packages include one each B87-QR or B91-QR flash bracket, FA-QR1 quick-release adapter, and MPR-CL rail.

How to Mount Portrait Perfect Package

Portrait Perfect Packages work with both conventional plates and L-plates, but only L-plates allow tripod mounting in vertical aspect. Clamp the MPR-CL onto camera body plate. Loosen QR Lock Knob and slide Flash Bracket into dovetail groove on top of MPR-CL. Tighten QR Lock Knob.

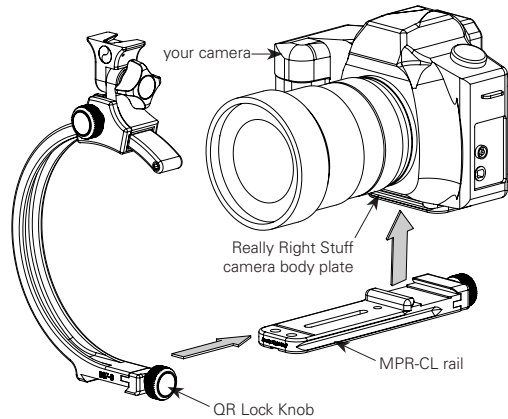

Using the Portrait Perfect Package

Hold and turn the camera as you would normally. While changing orientation, simply reach up with your left hand and push the Flash Mount to the matching detent along the Flash Ring. Now you're ready to shoot either handheld or from your tripod while always keeping the flash over the barrel of the lens.



ACCESSORIES

FA-QR1 & Other Flash Adapters

If you have multiple strobe cords or cold shoe mounts, add additional FA-QR1 adapters separately. Adapters are also available for Nikon SC-29 strobe cord & R200 strobes and Quantum QFlashes.

B87-QR & B91-QRFM FM Flash Mounts

Mount an accessory or second strobe to your Flash Bracket by adding another Flash Mount. Add FA-QR2 to mount an accessory; add FA-QRCS2 to mount a hotshoe strobe.

FA-QRCS2 Cold Shoe

When you're not going to use a strobe cord (i.e., trigger the strobe wirelessly or with a sync cord), add our insulated FA-QRCS2 cold shoe so that you can mount your strobe directly into the Flash Mount.

FA-QR2 Adapter

Add this flat adapter for mounting accessories such as microphones, LCD monitors, and other accessories.

FA-QREX1 & FA-QREX2 Flash Extenders

Telescoping Flash Extenders give your strobes more reach. Extenders provide anywhere from 4" to 10 1/4" of additional extension.

Use with Gimbal Heads

The unique orbiting action of our Flash Mount allows our flash bracket to be used on gimbal heads and side mount action heads such as the Really Right Stuff PG-02 FG and PG-02 LLR. Can also be used with Wimberley heads, Kirk King Cobra, Jobo, etc.

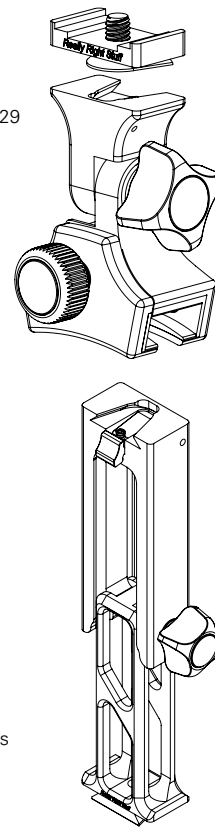

PG-02 FG
Full Gimbal
with B91-QR

PG-02 LLR
Side-Mount
with B91-QR

Dual Strobes are Great for Macro

Dual strobes can dramatically affect lighting for macro photography. By using a combination of flash extenders on multiple Really Right Stuff tilting Flash Mounts, you will have ultimate control over the distance and angles of your strobes. See our website for more creative solutions for macro photography.



MAINTENANCE

General Care

The flash bracket is finished with a protective anodize plating that protects it from corrosion and mild abrasion. It will not protect it from scraping or dropping on rocks, concrete, etc.

Cleaning

Take whatever precautions you can to prevent your flash bracket from getting fouled in mud, dirt, or sand. Lightly rinse mud or salt water with fresh water and then thoroughly dry. All the knobs are captive, meaning they cannot come off without damaging them so do not attempt to remove the knobs. If fine sand/grit fouls the knobs, simply run a gentle stream of water around the knob while rotating it one-half turn back and forth. **Do not disassemble your Flash Mount for cleaning.**

Lubrication

Your Flash Mount is lubricated at the factory and parts that require lubrication are sealed. NO LUBRICATION IS REQUIRED BY THE USER. Just keep the components free from contamination to maintain smooth action.

GUARANTEE

All Really Right Stuff brand products are guaranteed to the original purchaser to be free of defects in materials or workmanship for five (5) years from the date of purchase. Products will be repaired or replaced at our option.